

KORDON
 installed to brickwork
 as DPC (if required)
 continuous to engaged pier

KORDON
 installed on
 pier

engaged pier
 continuous base
 apron wall
 ground line

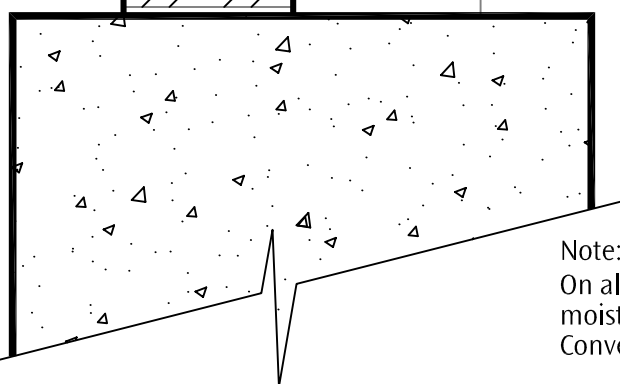

Note:
 On all piers and stumps, Kordon meets ant cap and
 moisture membrane requirements.
 Conventional ant caps can be placed on top of Kordon.



KORDON TERMITE BARRIER



Bayer Environmental Science

Subject

brick veneer - bearers & joist

Sheet No.

kd 052a



CODEMARK™
 GM-07-CM30001