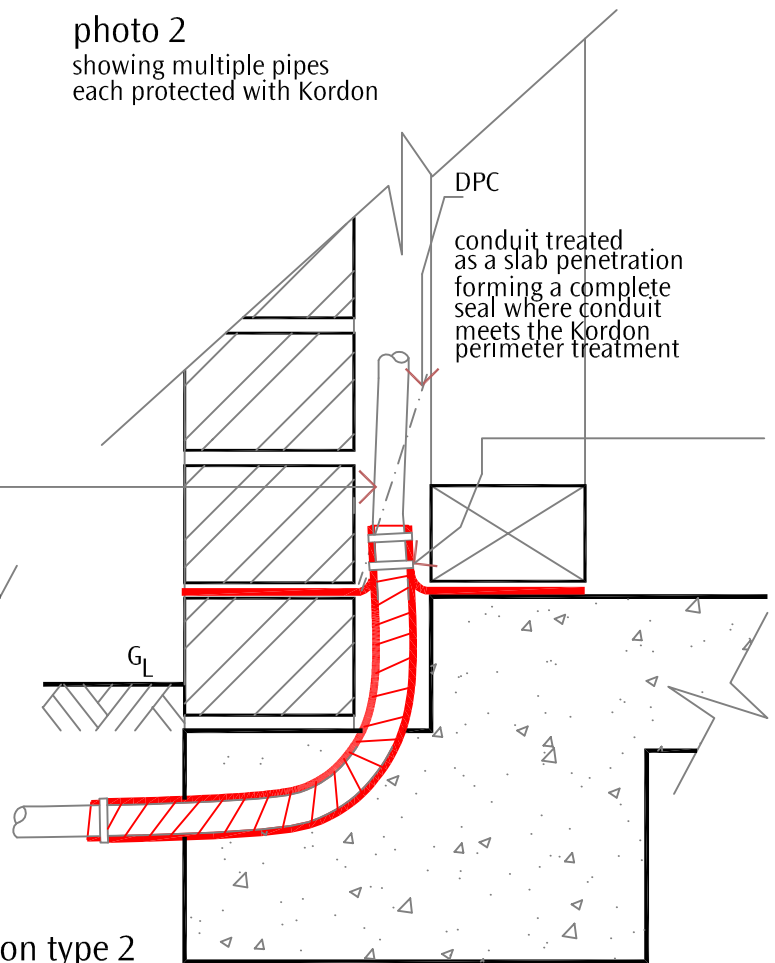
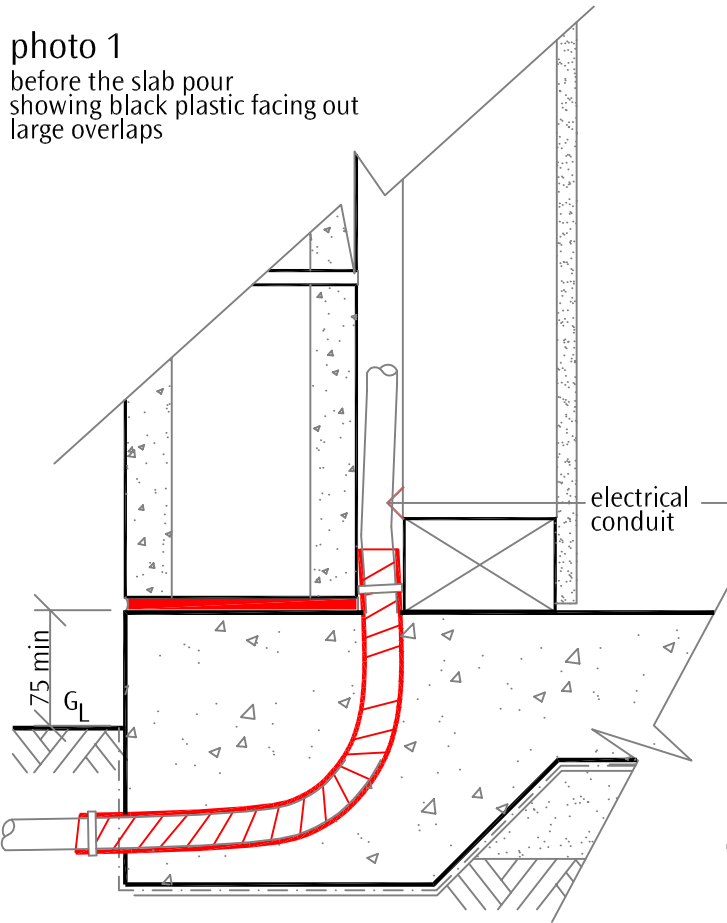

photo 1
before the slab pour
showing black plastic facing out
large overlaps

photo 2
showing multiple pipes
each protected with Kordon



section type 1

section type 2

Notes:

- wrap Kordon TB around (with overlap) electrical conduits penetrating the slab at length of 300mm approx.
- Kordon TB should be visible after the pour on any conduit /water pipe.
- a cable tie is to be secured at the start and at the finish of the wrap
- where possible place a 300x300 Kordon TB patch at the base of the slab penetration.
- where a cluster of conduits are installed - each conduit must be wrapped separately as above.

 **KORDON TERMITE BARRIER**



Bayer Environmental Science

Subject

conduits

Sheet No.

kd 009



CODEMARK™
GM-07-CM30001