

HALL

VERANDAH

**KORDON TB**

slap edge perimeter  
securely fixed by installer  
to manufacturer's specifications  
under the bottom channel

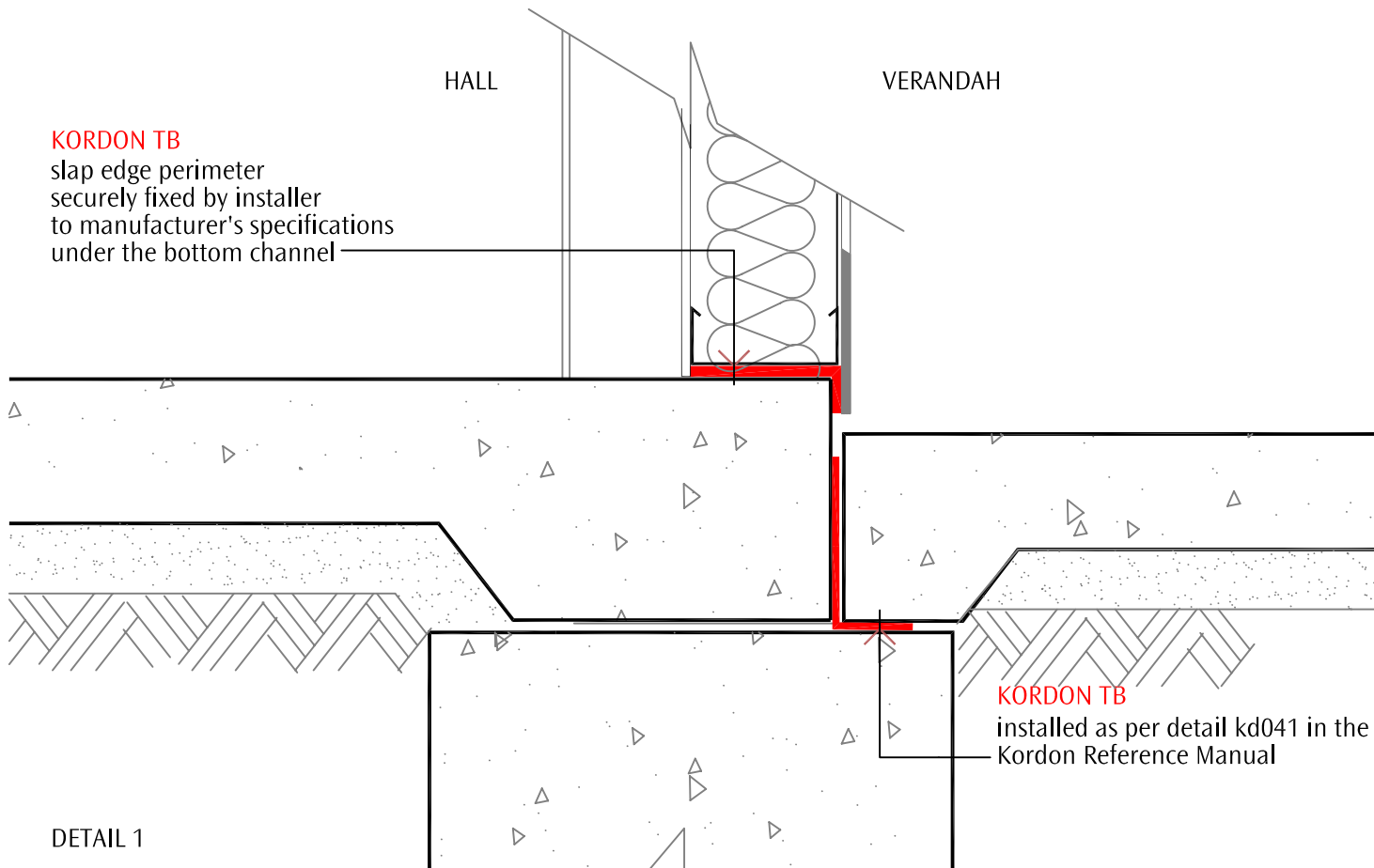

**KORDON TB**

installed as per detail kd041 in the  
Kordon Reference Manual

DETAIL 1

**KORDON TB**

slap edge perimeter  
securely fixed by installer  
to manufacturer's specifications

**KORDON TB**

installed as per detail kd041 in the  
Kordon Reference Manual

ground line

STORE

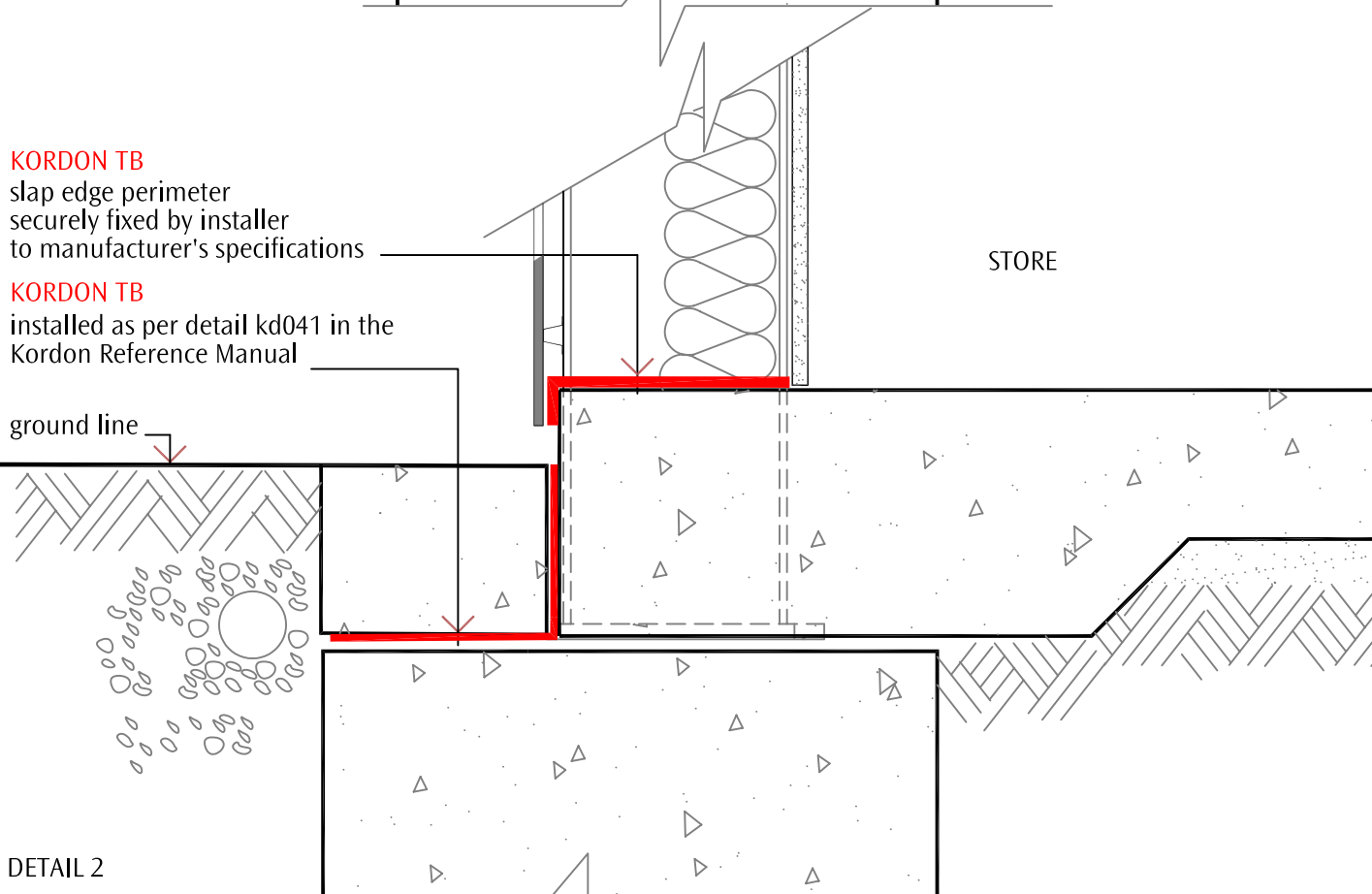

DETAIL 2



**KORDON TERMITE BARRIER**



Bayer Environmental Science

Subject

Sheet No.

portal frame construction

**kd 064**